

 **PowerProtect<sup>+</sup>**  
**uPVC Duct Bends - Power****Product Description**

Emtelle uPVC Power Duct bends are manufactured from a solid wall duct and provide the means to change direction and/or depth on a ducted network and also to meet the termination of the cable at the point of use (Hockey Stick).

All bends come with an interference fit socket as standard, with the opposable end being a spigot. Interference ring seal sockets are available in 110mm, 160mm, 200mm & 250mm OD sizes.

Bends are available in Class 1 and Class 2 and are formed from duct manufactured to Emtelle Generic Specification EF450-014 uPVC Duct (Power) and should only ever be used with this duct.

**Application**

All bends for power application are long radius to meet the requirements of High & Low Voltage Cables. Emtelle recommend checking the bend radius of the cable before specifying the bend size.

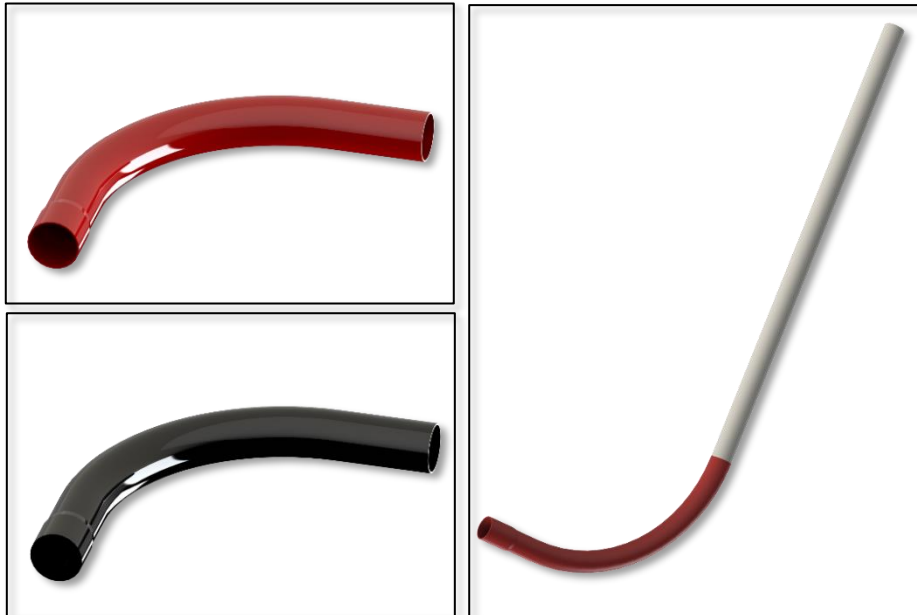
**Material & Technical data**

Raw Materials are uPVC resin and other additives suitable for the required properties of the finished product

This document is intended as a guide only. Whilst the information it contains is believed to be correct, Emtelle can take no responsibility for actions taken based on the information contained in this document. Emtelle reserves the right to make changes to this document without notice. All sales of product are subject to Emtelle's terms and conditions of sale only, which can be found on Emtelle's website.

This document is protected by copyright (c) Emtelle Group [2021]. The products depicted are protected by intellectual property rights. Any unauthorized copying of this document or of our products is prohibited and Emtelle UK Limited will take action to prevent any infringement of its rights and to claim damages for the loss that it suffers.

[www.emtelle.com](http://www.emtelle.com)

## Colours

Standard colours are **Black & Red**. 38mm Hockey Sticks are available in **White**.  
*Other colours available upon request.*

## Standard Dimensions & Product Codes

Nominal OD of Duct (mm)	Angle (deg°)	Radius (m)	Nominal OD of Duct (mm)	Angle (deg°)	Radius (m)
38	90°	0.4	140	11 ¼°	3.9
38*	90°	0.4	140	22 ½°	1.95
			140	22 ½°	3.9
43**	90°	0.4			
53.9	22 ½°	0.35			
88.9	11 ¼°	1.5	160	11 ¼°	0.56
88.9	11 ¼°	3.9	160	11 ¼°	1.2
88.9	22 ½°	1.5	160	11 ¼°	3.9
88.9	22 ½°	3.9	160	22 ½°	0.56
			160	22 ½°	1.2
			160	22 ½°	3.9
			160	45°	0.56
			160	45°	1.2
			160	90°	0.56
			160	90°	1.2
96.5	11 ¼°	3.8			
96.5	22 ½°	2.585			
96.5	45°	0.35			
96.5	90°	0.427			
110	11 ¼°	0.7	168	22 ½°	3.9
110	11 ¼°	1.2			
110	11 ¼°	3.5			
110	22 ½°	0.7	180	22 ½°	3.9
110	22 ½°	1.2			
110	22 ½°	1.75			
110	45°	0.56	200	11 ¼°	3.9
110	45°	1.2	200	22 ½°	3.9
110	90°	0.45			
110	90°	1.2			
125	11 ¼°	1.2	225	11 ¼°	3.9
125	11 ¼°	3.9	225	22 ½°	3.9
125	22 ½°	1.2			
125	22 ½°	3.9			
125	45°	1.2			
125	90°	1.2	250	11 ¼°	3.9
			250	11 ¼°	4.5
			250	22 ½°	3.9

## Packaging and Labelling

uPVC bends are supplied in either non-returnable woven polypropylene sacks which are biodegradable, or strapped. The sacks are designed to be stored on an even, dry and stable area; they are not to be stacked upon.

This document is intended as a guide only. Whilst the information it contains is believed to be correct, Emtelle can take no responsibility for actions taken based on the information contained in this document. Emtelle reserves the right to make changes to this document without notice. All sales of product are subject to Emtelle's terms and conditions of sale only, which can be found on Emtelle's website.

This document is protected by copyright (c) Emtelle Group [2021]. The products depicted are protected by intellectual property rights. Any unauthorized copying of this document or of our products is prohibited and Emtelle UK Limited will take action to prevent any infringement of its rights and to claim damages for the loss that it suffers.