

MHT1976

Issue D



Product Title: **Access Chambers/Stakka/Ultima**

Product Code: listed in documentation



Product Description

Suitable for use in road surfaces (D400 / E600) with fast moving traffic, or in footpaths, car parks, grass verges and areas with slow moving traffic including HGV's (B125 / A15)) as designated by their performance limitations.

The STAKKAbox™ Ultima sectional box system consists of pre-formed ring sections of depth 150mm which can then be stacked on top of each other to form chambers of varying depths. Each ring section is made of twin walls with vertical ribs spanning between the walls and castellated to positively interlock with its neighbour above and below.

When these rings are stacked the access chambers may then be used for footway and roadway installations and comply to EN124 (European Standard for Manhole covers) Classes B125 & D400 (right type of lid must be used). They can be badged with manufacturers ID/EN124/Kitemark/Class rating.

*NOTE: Manufacturers installation instructions to be adhered to at all times and are available upon request.

Material/Technical Specification

Ring:	SMC (Sheet Moulding Compound) Glass re-enforced Polyester Resin,
15% Glass. Base:	HDPE
Operating Temperature Range:	-60° to +160°C

Compliant Standards

- EN124 Class B125 – Vertical Loading requirements (Concrete covers and frames)
- EN124 Class D400 – Vertical Loading requirements (Ductile iron covers and frames)
- EN124 Class E600 – Vertical Loading requirements (Ductile iron covers and frames)
- BS5834-4, 1993 – Side wall loading for small access chambers
- BS1247-2 – Cold impact test
- EN228 – Resistance to Petrol and Chemicals
- EN295-3 – Stress Relief
- BS2782-4 – Methods 430A – 430D Water absorption

This document is intended as a guide only. Whilst the information it contains is believed to be correct, Emtelle can take no responsibility for actions taken based on the information contained in this document. Emtelle reserves the right to make changes to this document without notice. All sales of product are subject to Emtelle's terms and conditions of sale only, which can be found on Emtelle's website.

This document is protected by copyright (c) Emtelle UK Limited [2019]. The products depicted are protected by intellectual property rights. Any unauthorized copying of this document or of our products is prohibited and Emtelle UK Limited will take action to prevent any infringement of its rights and to claim damages for the loss that it suffers.

www.emtelle.com

MHT1976

Issue D

Product Table

Product Code	Type	Dimensions (L x W in mm)	Weight (kg)	Items / Pallet	Pallet Weight
9197	Ring	600 x 450	5.5	40	220kg
9183	Ring	610 X 610	9.1	20	182kg
9117	Ring	900 x 450	TBC	32	TBC
70473	Ring	900 X 600	TBC	24	TBC
70472	Ring	900 X 900	TBC	24	TBC
9117, 9117H1 **	Ring	915 X 445	10.4	20	208kg
9199	Ring	1160 X 380	14.8	20	296kg
9124, 9124H1 **	Ring	1220 X 675	15.2	24	152kg
5397, 5397H1 **	Ring	1310 X 610	14.2	10	142kg
9185	Ring	1500 X 750	16.4	10	164kg
70475	Ring	1705 X 710	TBC	15	TBC
70474	Ring	1800 X 675	TBC	24	TBC
70476	Ring	2885 X 710	TBC	15	TBC

Product Code	Type	Dimensions (L x W in mm)	Weight (kg)	Items / Pallet	Pallet Weight
9198	Base	600 x 450	9.8	32	313.6kg
9184	Base	610 X 610	14.6	16	233.6kg
9118	Base	915 X 445	16.5	16	264kg
9200	Base	1160 X 380	21.4	16	342.4kg
9123	Base	1220 X 680	26.4	8	211.2kg
5396	Base	1310 X 610	25.3	8	202.4kg
9186	Base	1500 X 750	31.3	8	250.4kg

Please note that a base section is a standard ring section complete with base fitted.

** ring section with pre-drilled holes (110mm Ø)

Applications

Telecoms, Gas, Rail, Electricity, Motorway Communication, Traffic Signalling and Street Lighting.

This document is intended as a guide only. Whilst the information it contains is believed to be correct, Emteille can take no responsibility for actions taken based on the information contained in this document. Emteille reserves the right to make changes to this document without notice. All sales of product are subject to Emteille's terms and conditions of sale only, which can be found on Emteille's website.

This document is protected by copyright (c) Emteille UK Limited [2019]. The products depicted are protected by intellectual property rights. Any unauthorized copying of this document or of our products is prohibited and Emteille UK Limited will take action to prevent any infringement of its rights and to claim damages for the loss that it suffers.

www.emteille.com

MHT1976

Issue D

Ring Sections (H1) with Holes

Hole diameter is 110mm and located centrally on both end faces

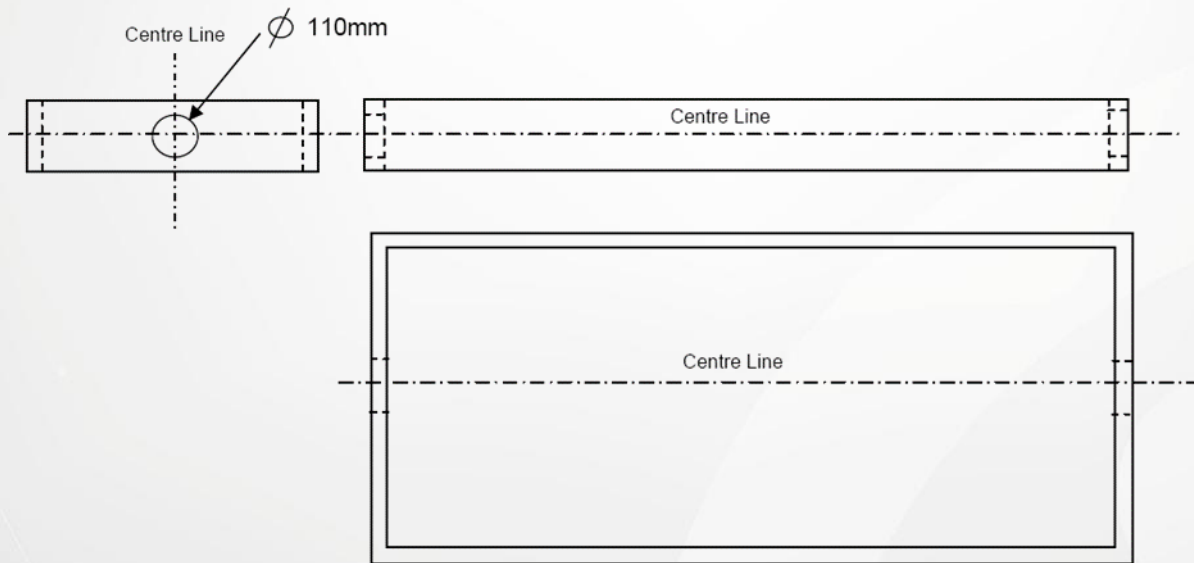

Health & Safety

Please ensure that when moving or lifting heavy objects, the appropriate lifting machinery or equipment is used.

Packaging and Labelling

The product shall be supplied suitably protected in recyclable material where possible, and foreseen with a label with product code and Emtelle product description where possible.

Change Documentation

Issue 1

Release date: 09-04-2010

Combination of various data-sheets
MHT 1976 + UK_DS_7997

This document is intended as a guide only. Whilst the information it contains is believed to be correct, Emtelle can take no responsibility for actions taken based on the information contained in this document. Emtelle reserves the right to make changes to this document without notice. All sales of product are subject to Emtelle's terms and conditions of sale only, which can be found on Emtelle's website.

This document is protected by copyright (c) Emtelle UK Limited [2019]. The products depicted are protected by intellectual property rights. Any unauthorized copying of this document or of our products is prohibited and Emtelle UK Limited will take action to prevent any infringement of its rights and to claim damages for the loss that it suffers.

www.emtelle.com