

## UK\_DS\_SFCConn

**FibreFlow**<sup>TM</sup>  
 Small Form Connector Range

### Product Description

This range of Push fit connectors offers straight and reducing connectors and end caps that form pressure-tight connections and seals for the appropriately sized microduct. The fittings are suitable for direct burial with a fully transparent body for easy visual inspection of the connection and the presence of fibre/cable. Pre-installed locking clips prevent accidental disconnection. The connection can be released by simply removing the safety clip and pressing down on the release ring. No additional assembly steps or tools are required for plugging. The internal clamping teeth made of corrosion-resistant stainless steel ensure a long-term and secure connection. The fittings comply with EN 50411-2-8 and EN61386-24 and are suitable for use for more than 20 years.

### Design Features

- ⊗ Safety pre-installed locking clip system to prevent microducts being accidentally disconnected.
- ⊗ Fully transparent (clear) body for ease of visual inspection to ensure the tube is inserted correctly.
- ⊗ Easy connection & disconnection of the duct thanks to the intelligent gripping system.
- ⊗ Compact design in compliance with Telecom standards.
- ⊗ Corrosion-resistant stainless steel clamping teeth.
- ⊗ Suitable for Direct Buried installations.

### Specifications

#### Standards:

Connectors manufactured in compliance with EN 50411-2-8, REACH directive 1907/2006 and RoHS 3 2015/863/EU

#### Working Pressures and Temperatures:

Blowing Pressure (max):	16Bar
Burst pressure according to EN 50411-2-8	
Minimum/Maximum working temperature:	-20°C to +50°C

This document is intended as a guide only. Whilst the information it contains is believed to be correct, Emtelle can take no responsibility for actions taken based on the information contained in this document. Emtelle reserves the right to make changes to this document without notice. Purchase of Emtelle products does not convey any licence under patents or other intellectual property rights owned by third parties. All sales of product are subject to Emtelle's terms and conditions of sale only, which can be found on Emtelle's website. This document is protected by copyright (c) Emtelle Group [2022]. The products depicted are protected by intellectual property rights. Any unauthorized copying of this document or of our products is prohibited and Emtelle UK Limited will take action to prevent any infringement of its rights and to claim damages for the loss that it suffers. [www.emtelle.com](http://www.emtelle.com)

## UK\_DS\_SFCConn

**Material:**

Body:	Transparent PA
Cartridge:	Black POM
Collet:	Black POM
Support Ring:	Orange POM
Seals:	NBR suitable for gas
Lock Claw:	Stainless Steel
Tamper proof lock clip:	Orange POM



## Dimensions

Product Code	ØD (mm)	ØE (mm)	ØA (mm)	L (mm)
76597	5	14.2	4.3	34.2
76608	7	14.9	6.0	34.6
76598	8	16.4	7.0	38.6
76609	10	18.5	9.0	42.8
76611	12	21.0	11.0	48.2
76599	14	24.9	13.0	50.6
76590	16	27.8	15.0	54.6
76600	20	33.0	19.0	61.0

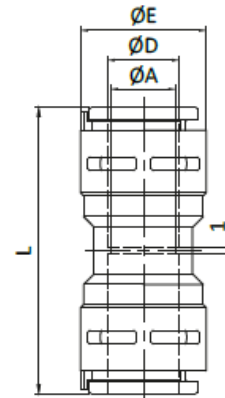

Product Code	ØD (mm)	ØE (mm)	L (mm)
76601	7	14.9	17.9
76591	8	16.4	20.5
76602	10	18.5	22.1
76592	12	21.0	25.1
76603	14	24.9	26.3
76593	16	27.8	29.3
76604	20	33.0	32.8

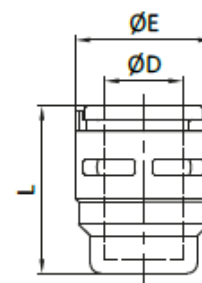

This document is intended as a guide only. Whilst the information it contains is believed to be correct, Emtelle can take no responsibility for actions taken based on the information contained in this document. Emtelle reserves the right to make changes to this document without notice. Purchase of Emtelle products does not convey any licence under patents or other intellectual property rights owned by third parties. All sales of product are subject to Emtelle's terms and conditions of sale only, which can be found on Emtelle's website. This document is protected by copyright (c) Emtelle Group [2022]. The products depicted are protected by intellectual property rights. Any unauthorized copying of this document or of our products is prohibited and Emtelle UK Limited will take action to prevent any infringement of its rights and to claim damages for the loss that it suffers. [www.emtelle.com](http://www.emtelle.com)

## UK\_DS\_SFCConn

Product Code	ØD1 (mm)	ØD2 (mm)	ØE1 (mm)	ØE2 (mm)	ØA (mm)	L (mm)
76594	7	5	14.9	14.2	4.3	34.4
76595	10	7	18.5	14.9	6.0	38.6
77295	12	10	21.0	18.5	9.1	45.9
76606	14	10	24.9	18.5	9.1	47.1
76596	14	12	24.9	21.0	11.0	49.4
76607	20	14	33.0	24.9	13.1	57.8

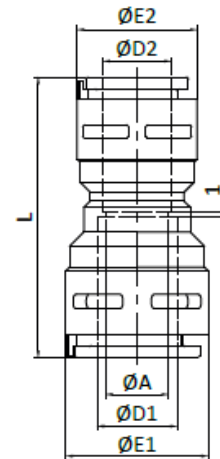

## Installation Instructions



Make sure that the microduct external size and the push-in system size of the connector are the same. The part of the microduct that has to be inserted into the connector must be round. The microduct must be cut square (90° angle) to enable a perfect connection.

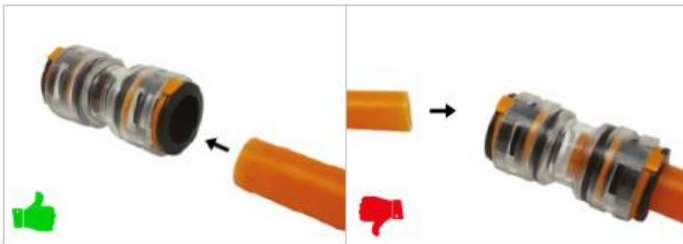

Make sure that the microduct is fully inserted. The transparent body of the connector allows a visual inspection of the correct and full insertion of the microduct.



In order to disconnect the microduct from the connector, remove locking clip first, then push the collet towards the connector body and pull the microduct keeping the collet pushed against the connector body.

## Packaging and Labelling

All products suitably packaged in recyclable materials and clearly labelled with Emtelle Product Code and Description where possible.

## END OF SPECIFICATION

This document is intended as a guide only. Whilst the information it contains is believed to be correct, Emtelle can take no responsibility for actions taken based on the information contained in this document. Emtelle reserves the right to make changes to this document without notice. Purchase of Emtelle products does not convey any licence under patents or other intellectual property rights owned by third parties. All sales of product are subject to Emtelle's terms and conditions of sale only, which can be found on Emtelle's website. This document is protected by copyright (c) Emtelle Group [2022]. The products depicted are protected by intellectual property rights. Any unauthorized copying of this document or of our products is prohibited and Emtelle UK Limited will take action to prevent any infringement of its rights and to claim damages for the loss that it suffers. [www.emtelle.com](http://www.emtelle.com)