



Tierre Connectors
Product Code: See Table



Product Description

Push-Fit connector for blown fibre microduct systems. Through connectors supplied shall provide a suitable and effective microduct to microduct joint and allow through blowing under pressure of fibre unit or microcable without snagging. Dark rubber covers available to achieve higher impact rating at extremes of temperature.

Specification

- Standards:** Products meet and, in many cases, exceeds the performance criteria of EN 50411-2-8.
The results are based on the testing being performed at 22°C.
- Working Pressures and Temperatures:**
Blowing pressure (max) 16Bar
Minimum maximum working temperature: -20°C to +50°C
- Dimensions:**
Maximum external dimensions:

Straight Connector

Microduct OD (mm)	Impact Rating (J)	ØA (mm)	L (mm)	Connector Code
3	10	14.8	33.0	TBC
5	15	16.8	35.2	74230
7	15	18.8	39.1	74232
8	15	18.8	39.1	74011
10	15	22.2	46.4	74224
12	15	25.0	49.2	74226
14	15	26.7	50.2	74228
16	TBC	29.2	55.6	74537
18	15	32.0	59.1	74539
20	15	34.0	41.2	TBC

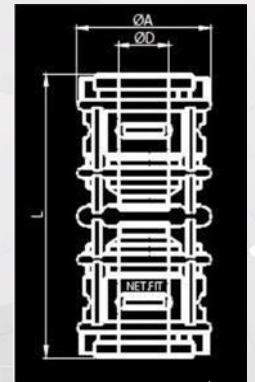

Reducer Connector

Microduct OD (mm)	ØD1 (mm)	ØD2 (mm)	ØE1 (mm)	ØE2 (mm)	L (mm)	Connector Code	Cover code
14	14	10	26.7	22.2	48.3	TBC	-
14	14	12	26.7	22.2	48.3	75531	-
16	16	12	29.2	26.7	52.4	74524	-
16	16	14	29.2	26.7	53.1	TBC	-

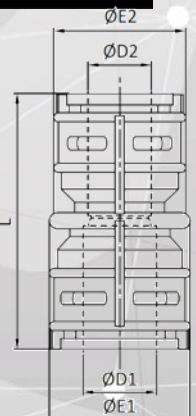

This document is intended as a guide only. Whilst the information it contains is believed to be correct, Emtelle can take no responsibility for actions taken based on the information contained in this document. Emtelle reserves the right to make changes to this document without notice. All sales of product are subject to Emtelle's terms and conditions of sale only, which can be found on Emtelle's website.

This document is protected by copyright (c) Emtelle Group [2020]. The products depicted are protected by intellectual property rights. Any unauthorized copying of this document or of our products is prohibited and Emtelle UK Limited will take action to prevent any infringement of its rights and to claim damages for the loss that it suffers.

UK DS TCONNECTOR

Issue: J 03/09/2020

Page 2 of 2

End Cap

Microduct OD (mm)	Impact Rating (J)	ØA (mm)	L (mm)	Connector Code
3	7	14.8	18.3	TBC
5	6	16.8	19.5	74231
7	15	18.8	21.5	74233
8	11	18.8	21.5	74223
10	10	22.2	25.1	74225
12	15	25.0	26.3	74227
14	15	26.7	27.0	74229
16	TBC	29.2	29.9	74540
18	15	32.0	31.5	74538
20	11	34.0	33.0	TBC

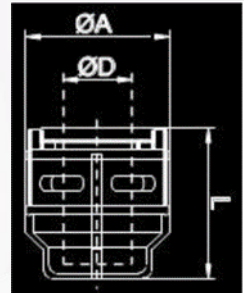

4. Materials:

Body:	Transparent PA
Cartridge:	Black POM
Collet:	Black POM
Support Ring	Orange POM
Seals:	NBR suitable for gas
Lock Claw	Stainless Steel
Tamper proof lock clip	Orange POM
Rubber Cover	Dark Silicon

This document is intended as a guide only. Whilst the information it contains is believed to be correct, Emtelle can take no responsibility for actions taken based on the information contained in this document. Emtelle reserves the right to make changes to this document without notice. All sales of product are subject to Emtelle's terms and conditions of sale only, which can be found on Emtelle's website.

This document is protected by copyright (c) Emtelle Group [2020]. The products depicted are protected by intellectual property rights. Any unauthorized copying of this document or of our products is prohibited and Emtelle UK Limited will take action to prevent any infringement of its rights and to claim damages for the loss that it suffers.

www.emtelle.com